

SC-WP1 Wall Panel

D1541 - Black

D1542 - White

1. Safety Instructions



Important

Read and follow the instructions in this user manual before installing, operating or servicing this product.



DANGER

Danger for children

For adult use only. The device must be installed beyond the reach of children.

- Do not leave various parts of the packaging (plastic bags, polystyrene foam, nails, etc.) within children's reach. Packaging material is a potential source of danger for children.



Attention

General safety

- Do not shake the device. Avoid brute force when using the device.
- If the device is exposed to extreme temperature variations (e.g. after transportation), do not switch it on immediately. Let the device reach room temperature before switching it on, otherwise it may be damaged by the formed condensation.
- If the device fails to work correctly, discontinue the use immediately.



Attention

This device shall be used only for the purposes it is designed for.

This device is designed to be used as a wall remote control panel. Any incorrect use may lead to hazardous situations and result in injuries and material damage.

This device does not contain user-serviceable parts. Unauthorized modifications to the device will render the warranty void. Such modifications may result in injuries and material damage.



Attention

Do not expose the device to conditions that exceed the rated IP class conditions.

This device is IP20 rated. IP (Ingress Protection) 20 class provides protection against solid objects greater than 12 mm, such as fingers, and no protection against harmful ingress of water.

2. Before Using the Product

After unpacking, check the contents of the box. If any parts are missing, contact your Highlite International dealer.

Your shipment includes:

- Wall panel (A)
- Wall-box mounting frame (B)
- 2 x Front plates (C)
- Turn knob (D)
- 2 x Long screws (E)
- 2 x Short screws (F)
- User manual

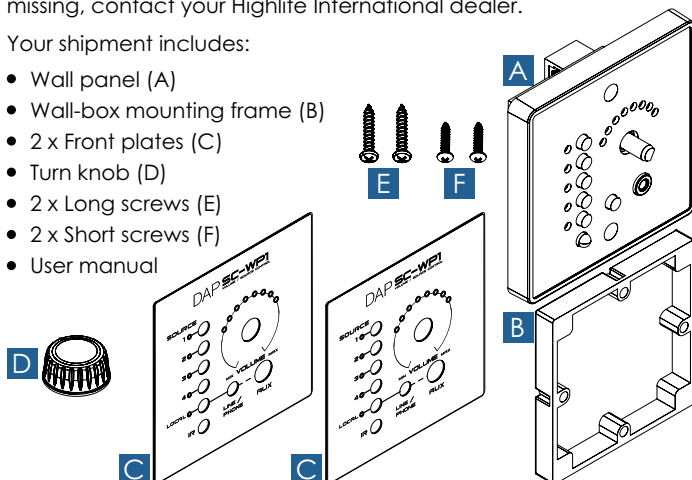

3. Description

The DAP SC-WP1 is a wall-mounted remote control panel for the DAP SC-5.2 Source Control (D1540).

For complete product specifications visit the respective product page on our website www.highlite.com.

The SC-WP1 is available in black and white:

- [D1541](#) – SC-WP1 Wall Panel – Black
- [D1542](#) – SC-WP1 Wall Panel – White

Front View

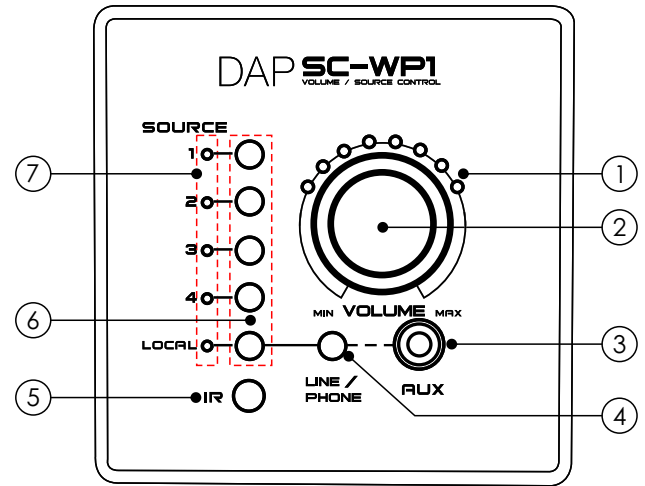

- 01) 8 volume LED indicators (green)
- 02) Volume control
- 03) Line/phone connector IN (3,5 mm jack)
- 04) Line/phone selection button
- 05) IR sensor
- 06) 5 source selection buttons: Sources 1–4 and Local
- 07) 5 LED indicators (amber): Sources 1–4 and Local

Back View

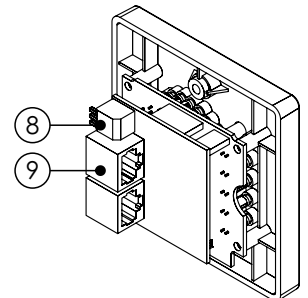

- 08) DIP switch (no function)
- 09) 2 RJ45 connectors

4. Setup

This figure shows a typical setup with the SC-5.2 Source Control (D1540), 5 sources, a wall panel (D1541/D1542), and an output device (active loudspeaker).

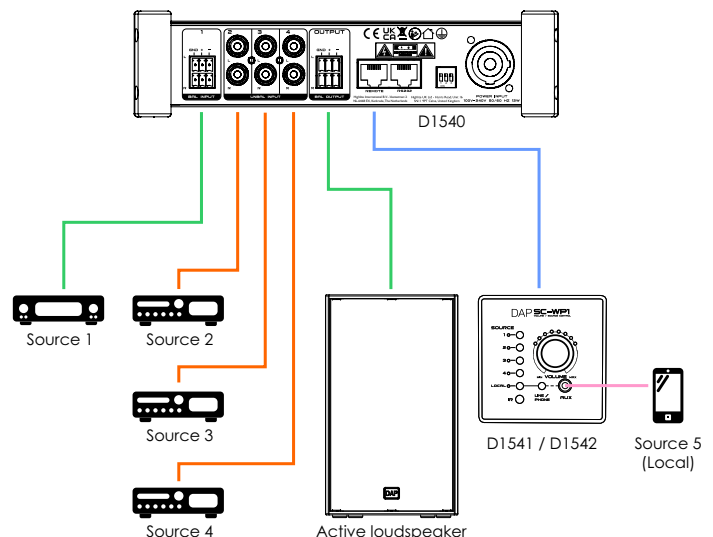

5. Installation



Attention
Install all cables before mounting the device.

The SC-WP1 can be installed in a standard 1-gang wall box.

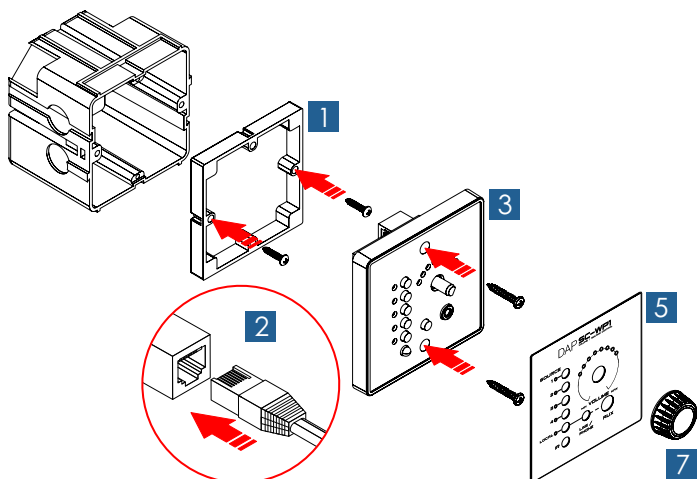

1 Attach the **wall-box mounting frame (B)** to the wall box with the **2 short screws (F)**.

2 Insert the CAT5/CAT6 cables into the **RJ45 connectors (09)** to connect the device to the SC-5.2 Source Control (D1540).

3 Attach the **wall panel (A)** to the **wall-box mounting frame (B)** with the **2 long screws (E)**.

4 Remove the tissue tape from the backside of the **front plate (C)**.

5 Carefully place the **front plate (C)** on the **wall panel (A)**. Make sure that the openings fit around the buttons.

6 Press firmly the **front plate (C)** to the **wall panel (A)** to attach it.

7 Fit the **turn knob (D)** on the rotary encoder of the volume control.



Attention
The device is powered from the connected SC-5.2 Source Control (D1540) via the connected CAT5/CAT6 cable.

6. Control Modes

You can control the device manually or with an IR remote control.

The IR remote control is supplied with the SC-5.2 Source Control (D1540). Refer to the user manual of the SC-5.2 Source Control (D1540) for the operation of the IR remote control.

7. Source Selection

Press one of the **source selection buttons (06)** to select a connected source device (Sources 1–4 or Local). The **LED indicator (07)** for the respective source lights up.

Note:

The 5th source connected via the wall panel (Local) can be selected only from the wall panel.

8. Local Input Selection

Press the **line/phone selection button (04)** to switch between line or phone input.

9. Adjusting the Volume

The device has an infinite rotary encoder with an integrated push switch to control the volume at the output.

Turn the **volume control (02)** clockwise to increase the output level. The 8 **volume LED indicators (01)** light up one after the other from left to right with the increase of the volume.

Turn the **volume control (02)** counterclockwise to decrease the output level. The 8 **volume LED indicators (01)** turn off one after the other from right to left with the decrease of the volume.

10. Mute

Press the **volume control (02)** to mute the output.

Press the **volume control (02)** again to clear the mute status. The volume returns to the last setting.

11. Remote Control

The IR remote control is supplied with the SC-5.2 Source Control (D1540). Refer to the user manual of the SC-5.2 Source Control (D1540) for more information.

Make sure that there is a clear line of sight between the remote control and the **IR sensor (05)**.

	Mute	Press to mute/unmute the output
	Volume +	Press to increase the volume
	Volume -	Press to decrease the volume
	Source	Press to select a source
	Zone	No function

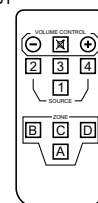

12. Troubleshooting

The device does not function at all	Make sure that the CAT5/CAT6 cable is firmly connected to the device. Make sure that the SC-5.2 Source Control is connected to the power supply and switched on. Make sure that the CAT5/CAT6 cable is not damaged.
No sound	Increase the volume.
The device does not respond to the remote control	Make sure that there is a clear line of sight between the remote control and the IR sensor. Change the battery in the remote control.

13. Maintenance



Attention
Do not immerse the device in liquid. Do not use alcohol or solvents to clean the device.

Clean the device with a soft, lint-free cloth.

The device does not contain user-serviceable parts. Do not open the device and do not modify the device.

14. Disposal



Dispose of this product by handing it to the respective collection point for recycling of electrical and electronic equipment. Do not dispose of with the household waste.

15. Approval



Check the respective product page on the website of Highlite International (www.highlite.com) for an available declaration of conformity.

© 2024 DAP. All rights reserved.

No part of this document may be copied, published or otherwise reproduced without the prior written consent of Highlite International.

Design and product specifications are subject to change without prior notice.

For the latest version of this document and other language versions, please visit our website www.highlite.com or contact us at service@highlite.com.